

UNOMAT[®]

INTERNATIONAL



Energy Storage Solutions
Off Grid Inverters

LINK Series



Off-grid solar rechargeable household inverter power supply

2KVA / 1600W with 50A solar charger

1KVA / 900W with 50A solar charger



Features:

High reliability system

- Advanced digital automatic control technology ensure the power durable and reliable;

Strong environment adaptability

- Wide input voltage and frequency range avoid frequent switching;
- 3 stages Intelligent Charging Control
- Off mode charging function

Full protection function

- Inverter short circuit and overload protection function Battery over discharge protection
- The batteries will be disconnected and protected once fully charged.
- Battery will be back discharge protection through solar PV panels.
- Solar cell module, Battery polarity reverse connection circuit protection
- Solar charge controller, inverter, and other internal short circuit protection.

Rear Panel:

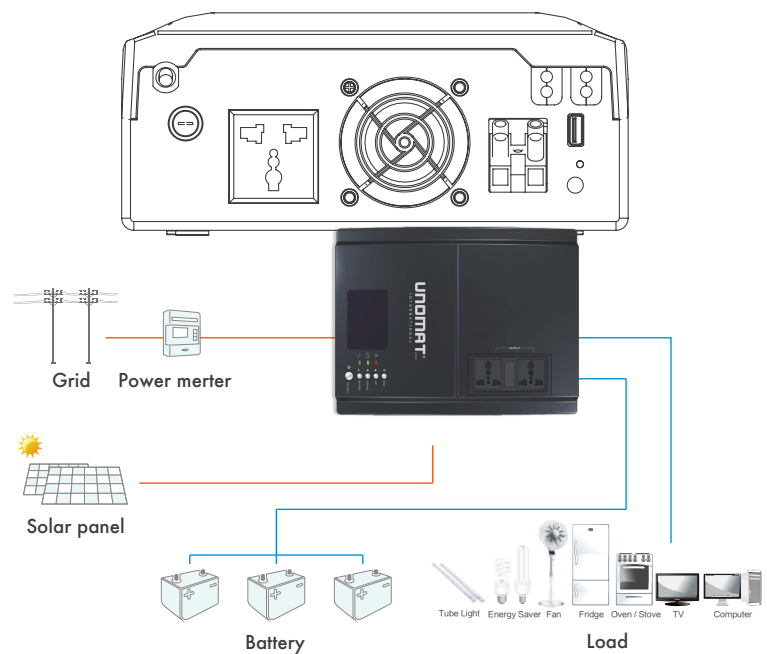

Technical Specifications

Model	LINK 1000	LINK 2000
Capacity	1000VA / 900W	2000VA / 1600W
Nominal Battery Voltage (Lead-acid battery)	12Vdc	24Vdc

LINE MODE

INPUT

Nominal Voltage	230Vac
Voltage Range	170~280Vac (Narrow range) 90~280Vac (Wide range)
Nominal Frequency	50Hz or 60Hz

OUTPUT

Voltage	230Vac
Frequency/Waveform	Tracking the Utility
Transfer Time	20ms Typical

BACKUP MODE

OUTPUT

Voltage	220/230/240Vac
Frequency	50Hz or 60Hz (Auto detection)
Waveform	Simulated Sine Wave
Protection	Low battery alarm, low battery shutdown, over charge protection, overload protection, over temperature protection, short circuit protection

Battery charger (Power by AC)

Charging algorithm	3-steps charging	
AC charging mode	10A/20A	10A/20A
Floating charging voltage	13.75±0.25V	27.50±0.50V
Overcharging voltage	15.30V	30.60V
Solar battery charger		
MAX. input power	600W	1200W
Charging current (PWM)	50A	
System DC Voltage	12Vdc	24Vdc
Optimal work voltage range	15V~18V	30V~32V
MAX. PV input current	40V	60V
MAX. PV input current	50A	

GENERAL

PHYSICAL

Dimension (D×W×H)	316×227×92mm	
Net Weight	3.1kg	3.3kg

ENVIRONMENT

Operating Environment	0~50°C, 0%~90% relative humidity (Non-condensing)	
Storage Environment	-15°C to 55°C, 0% to 90% humidity (Non-condensing)	
Noise Level	Less than 50dB	
Built-in USB Charger (5V×1A max)	Optional	
AC input voltage range selection	Yes	
AC charging current selection	Yes	
Low DC cut-off voltage setting	Yes	
AC output rating voltage selection	Yes	
Buzzer mute control	Yes	
Battery Voltage & load percentage display	Yes	

1. Specifications are subject to change without prior notice
2. Data above are typical values for reference only, not as a basis for engineering design